

**Manuals+** — User Manuals Simplified.



## Harley Benton 402819 Power Plant Power Bank User Guide

[Home](#) » [Harley Benton](#) » Harley Benton 402819 Power Plant Power Bank User Guide 📄

The Harley Benton logo, featuring the brand name in a large, black, cursive script font.

**PowerPlant Powerbank**

### Quick Start Guide

This quick start guide contains important information on the safe operation of the product. Read and follow the safety advice and instructions given. Retain the quick start guide for future reference. If you pass the product on to others please include this quick start guide.

## Contents

[1 Safety instructions](#)

[2 Features](#)

[3 Scope of delivery](#)

[4 Operating elements](#)

[5 Technical specifications](#)

[6 Documents / Resources](#)

[6.1 References](#)

[7 Related Posts](#)

## Safety instructions

### Intended use

This product is meant to be used for the mobile voltage supply of suitable devices.

Any other use or use under other operating conditions is considered to be improper and may result in personal injury or property damage. No liability will be assumed for damages resulting from improper use

### Danger for children



Ensure that plastic bags, packaging, etc. are disposed of properly and are not within reach of babies and young children. Choking hazard! Ensure that children do not detach any small parts from the product. They could swallow the pieces and choke!

Incorrect handling of lithium batteries can result in injury

- In the event of a short circuit, overheating or mechanical damage, lithium batteries can cause severe injuries.
- When handled correctly and appropriately lithium batteries pose no risk.
- Store lithium batteries in a cool, dry place, ideally in the original packaging.
- Store lithium batteries away from heat sources (e.g. radiators or sunlight).

Lithium batteries are hermetically sealed. Never attempt to open a lithium

battery.

- If the battery housing is damaged small amounts of the electrolyte may leak out. If this should happen, seal the lithium battery in airtight packaging and wipe up the traces of electrolyte using absorbent paper towels. You must wear protective rubber gloves when doing so. Clean your hands and the affected surface thoroughly with cold water.
- Never attempt to recharge non-rechargeable lithium batteries. When charging lithium batteries you must use a suitable charging device intended for the purpose.
- Before disposing of the device remove the lithium batteries. Protect used lithium batteries against potential short circuits, e.g. by covering the poles with adhesive tape.
- Only use powder extinguishers or other suitable extinguishing agents to extinguish a burning lithium battery.

Possible damage to lithium-ion batteries through incorrect storage By deep discharge, lithium-ion batteries can be permanently damaged or lose some of their capacity.

Before long breaks, charge the batteries to around 50 % of their capacity and then switch off the device. Store the device at room temperature or cooler in an environment as dry as possible.

If the batteries are stored for a longer period, recharge them to 50 % every three months.

Fully charge the batteries only shortly before use at room temperature.

### **Where to use the product**

#### **Never use the product**

- in conditions of extreme temperature or humidity
- in extremely dusty or dirty areas
- at locations where the unit can become wet

## General handling

- To prevent damage, never use force when handling the product.
- Never immerse the product in water. Just wipe it with a clean dry cloth. Do not use liquid cleaners such as benzene, thinners or flammable cleaning agents.

## Features



- Mobile voltage supply for pedals, amps, cell phones, etc.
- Automatic overload protection when charging
- Automatic shutoff on short circuits
- Reminds timely on due recharging
- Charge indicator via 4 LEDs, LED spotlight

## Scope of delivery

- √ 31 × USB charging cable
- √ 32 × 60 cm DC 9 V cable for effects devices
- √ 31 × 10 cm polarity DC adapter cable for effects devices
- √ 31 × daisy-chain DC cable with 5 connectors for effects devices

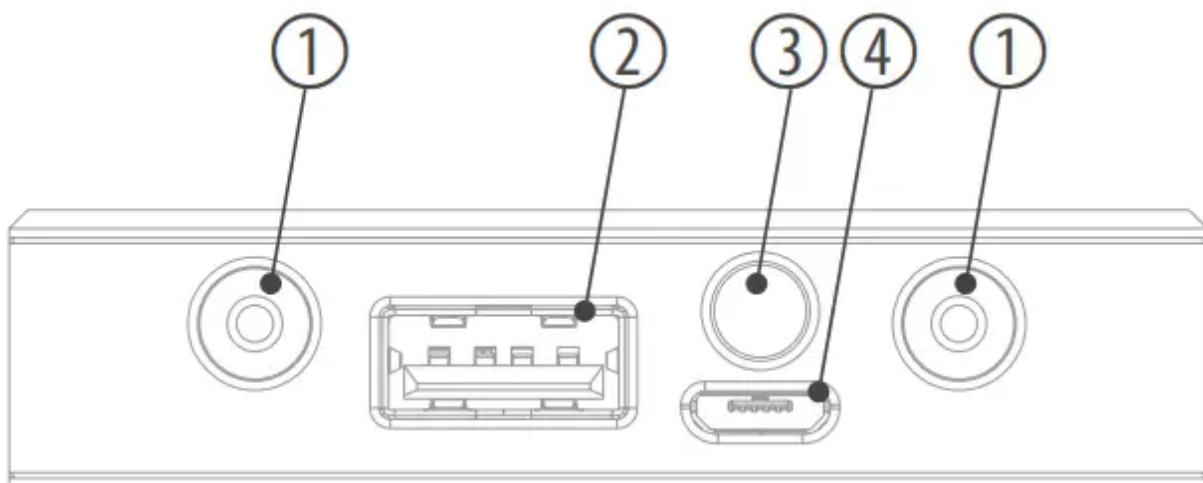
## Operating elements



1. 9 V  supply outlet for effects devices
2. 5 V  supply outlet, USB format
3. LED spotlight
4. Micro USB port to recharge the unit
5. 9 V voltage indicator, blue
6. 4-segment charge status indicator ( On / Off button

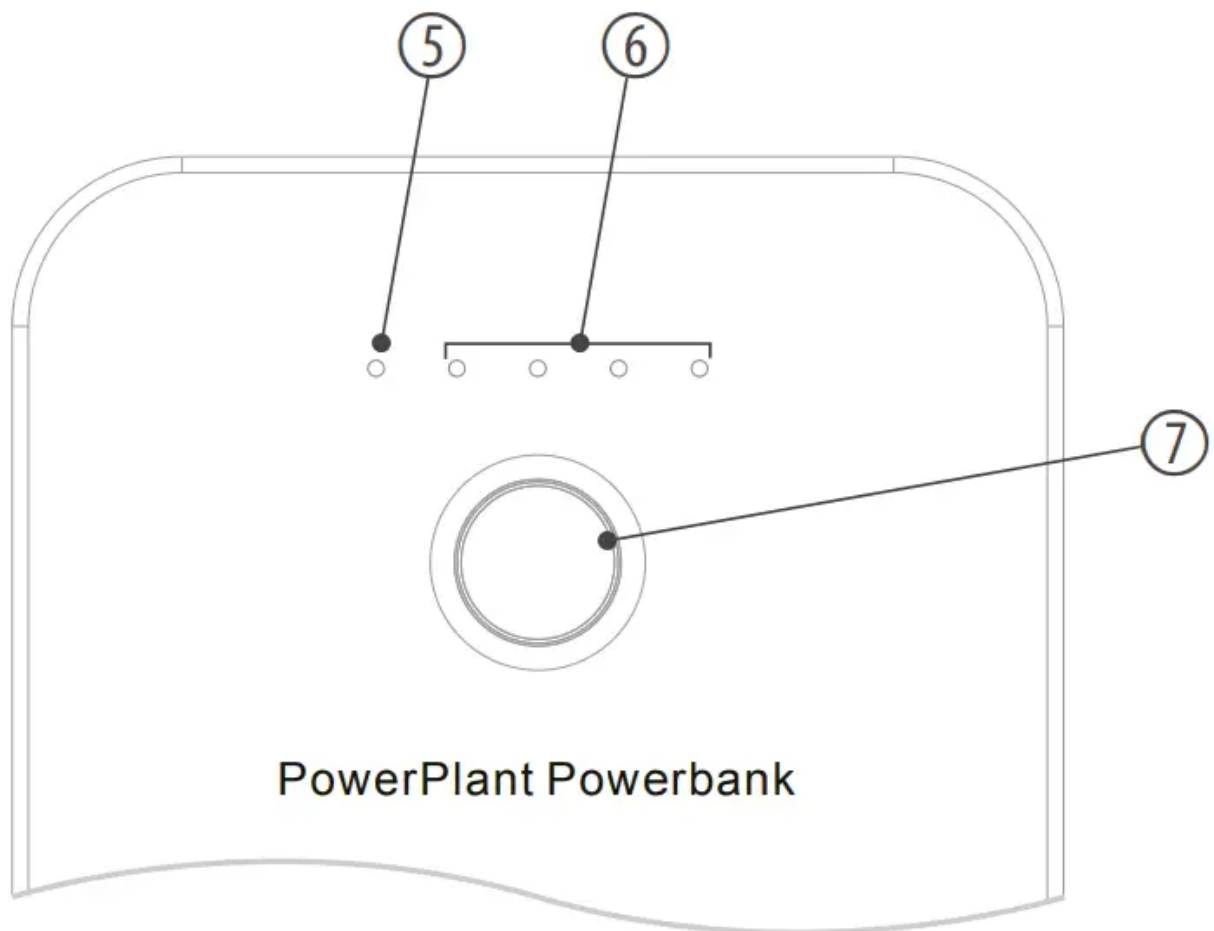

## Using the product

1. Press the On / Off button to turn the unit on. The blue 9 V voltage indicator

lights up and the four red LEDs to the right of it indicate the charge status:



4 LEDs lit: power level  $\geq 75\%$

3 LEDs lit: power level  $\geq 50\% \leq 75\%$

2 LEDs lit: power level  $\geq 25\% \leq 50\%$

1 LED lit: power level  $\geq 3\% \leq 25\%$

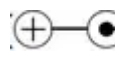
1 LED flashes: power level  $< 3\%$

2. Connect pedals or amplifiers with a maximum output power of 10 W to the 9 V  supply outlets via suitable cables for voltage supply. Make sure that the polarity of the devices to be connected is identical to the polarity of the power outlets (  ). Otherwise, there is a risk of property damage. Multiple pedals can be connected one after the other. Before connecting an amplifier, turn its volume control to 0.
3. Connect mobile phones or similar devices to the 5 V  supply outlet via suitable cables for voltage supply to charge their batteries. The Powerbank is automatically switched on.
4. Regardless of whether the unit is on or off, you can press the On / Off button twice in a row to switch the spotlight on or off.
5. To turn the Powerbank off, keep the On / Off button pressed for two seconds.
6. At the latest when a red LED flashes, you must recharge the Powerbank to continue using it.

For a long service life of the Powerbank, however, we recommend recharging already at a power level of approx. 25 %, i.e. when the penultimate charge status LED has been extinguished.

Also recharging after every 6 months of non-use increases the service life.

Use the supplied micro USB cable and a suitable power adapter (not supplied) that delivers 5 V at 2 A minimum.



Then the time for a full charge is about 5 hours.

If the power adapter delivers less than 2 A, the Powerbank is also charged, but the charging time is extended accordingly.

The Powerbank can also be charged during use.

When the four charge status indicators light up, charging is completed.

## Technical specifications

• Outputs		$2 \times 9 \text{ V}$  , 1.2 A max. (  ) $1 \times 5 \text{ V}$  , USB, 2.0 A max.
• Power supply		Micro USB
• Battery	Type	Lithium ions battery
	Voltage	3.7 V
	Capacity	10000 mAh
	Charging time	5 h
• Standby power consumption		120 $\mu\text{A}$
• 9 V output ripple		70 ~ 80 mV
• Dimensions (W × H × D)		148 mm × 65 mm × 17 mm
• Weight		220 g
• Ambient conditions	Temperature range	0 °C ... 40 °C
	Relative humidity	20 % ... 80 % (non-condensing)

For the transport and protective packaging, environmentally friendly materials have been chosen that can be supplied to normal recycling. Ensure that plastic bags, packaging, etc. are properly disposed of. Do not just dispose of this materials with your normal household waste, but make sure that they are

collected for recycling. Please follow the notes and markings on the packaging.

Batteries must not be thrown away or incinerated; they must be disposed of in accordance with local regulations for the disposal of hazardous waste. Use the existing collection points for this.

Dispose of lithium batteries only in discharged condition. Remove replaceable lithium batteries from the device before disposal. Protect used lithium batteries from short circuits, for example by covering the poles with adhesive tape. Permanently installed lithium batteries must be disposed of together with the device. Please inquire about a suitable acceptance point.

This product is subject to the European Waste Electrical and Electronic Equipment Directive (WEEE) in its currently valid version.

Do not dispose of your old device with your normal household waste. Dispose of this product through an approved waste disposal firm or through your local waste facility. Comply with the rules and regulations that apply in your country. If in doubt, consult your local waste disposal

facility.

## **Thomann GmbH**

- Hans-Thomann-Straße 1
- 96138 Burgebrach
- [www.thomann.de](http://www.thomann.de)
- [info@thomann.de](mailto:info@thomann.de)

DocID: 402819\_28.04.2021

## **Documents / Resources**

	<p><a href="#">Harley Benton 402819 Power Plant Power Bank</a> [pdf] User Guide 402819, Power Plant Power Bank</p>
--	--

## References

- [Buy musical instruments online from the market leader – United States](#)
- [User Manual](#)

### **Manuals+, Privacy Policy**

This website is an independent publication and is neither affiliated with nor endorsed by any of the trademark owners. The "Bluetooth®" word mark and logos are registered trademarks owned by Bluetooth SIG, Inc. The "Wi-Fi®" word mark and logos are registered trademarks owned by the Wi-Fi Alliance. Any use of these marks on this website does not imply any affiliation with or endorsement.